

Bee Campus USA - Medical University of South Carolina

Report on 2021

Pollinator Habitat Creation & Enhancement

While following strict COVID protocols, The MUSC Urban Farm utilized its weekly volunteer sessions to expand and enhance pollinator habitats on campus. During one of these volunteer sessions a group of volunteers helped create a new hybrid flower and herb pollinator bed by digging up perennial flowers from various ornamental flower beds around campus. The plant material removed from the flower beds was used in the creation of style pollinator habitat.

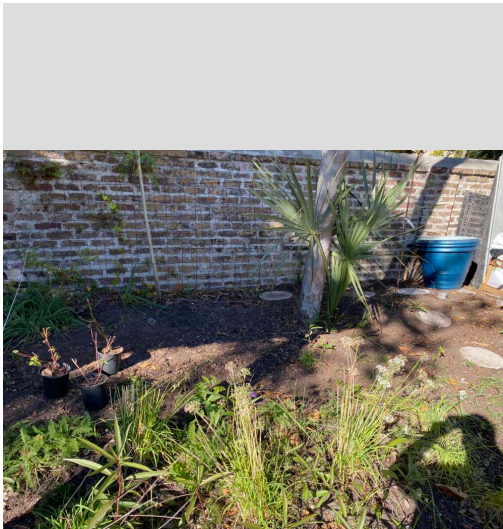

Before photo of area planted with herbs and flowers.

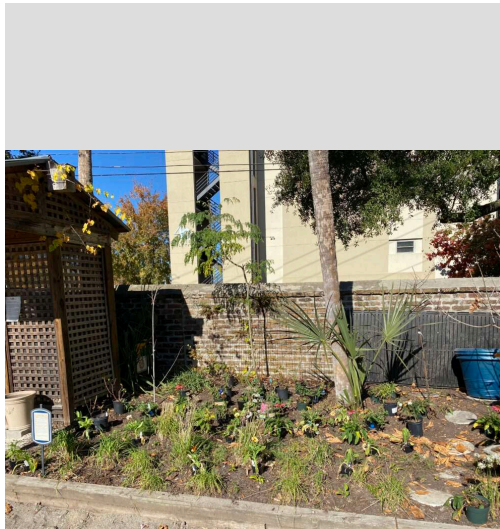

After the area was planted



Student Volunteer removing plants to be repurposed in the pollinator habitat.

Education & Outreach

Courses & Continuing Education



Service-Learning

Though Covid protocols made it difficult to plan projects in advance, we were able to utilize our approved volunteer sessions to engage groups in service-learning projects. One of these projects was the creation of a new rain garden using native plants. This was a great hands on educational project for a group of local high school students.



New rain garden planted by high school students



Educational Signage

Policies & Practices

Integrated Pest Management Plan: [bee campus hand out.docx](#)

<https://web.musc.edu/resources/health-and-wellness/arboretum/bee-campus>

Recommended Native Plant List:

<https://scnps.org/about-the-plants/sc-native-plant-list>

Recommended Native Plant Supplier List:

Learn More

urbanfarm@musc.edu

